

PEDESTRIAN  
ENTRANCE

5

S - N - C - U - R - S - T - R - E - E - T

EXISTING ENTRANCE: EXISTING ENTRANCE TO THE BUILDING FROM THE WEST SIDE OF THE STREET. THIS ENTRANCE IS TO BE RELOCATED TO THE EAST SIDE OF THE STREET. THE NEW ENTRANCE IS TO BE LOCATED AT THE CORNER OF THE BUILDING AND THE STREET. THE NEW ENTRANCE IS TO BE LOCATED AT THE CORNER OF THE BUILDING AND THE STREET. THE NEW ENTRANCE IS TO BE LOCATED AT THE CORNER OF THE BUILDING AND THE STREET.

EXISTING ENTRANCE: EXISTING ENTRANCE TO THE BUILDING FROM THE WEST SIDE OF THE STREET. THIS ENTRANCE IS TO BE RELOCATED TO THE EAST SIDE OF THE STREET. THE NEW ENTRANCE IS TO BE LOCATED AT THE CORNER OF THE BUILDING AND THE STREET. THE NEW ENTRANCE IS TO BE LOCATED AT THE CORNER OF THE BUILDING AND THE STREET. THE NEW ENTRANCE IS TO BE LOCATED AT THE CORNER OF THE BUILDING AND THE STREET.

EXISTING ENTRANCE: EXISTING ENTRANCE TO THE BUILDING FROM THE WEST SIDE OF THE STREET. THIS ENTRANCE IS TO BE RELOCATED TO THE EAST SIDE OF THE STREET. THE NEW ENTRANCE IS TO BE LOCATED AT THE CORNER OF THE BUILDING AND THE STREET. THE NEW ENTRANCE IS TO BE LOCATED AT THE CORNER OF THE BUILDING AND THE STREET. THE NEW ENTRANCE IS TO BE LOCATED AT THE CORNER OF THE BUILDING AND THE STREET.

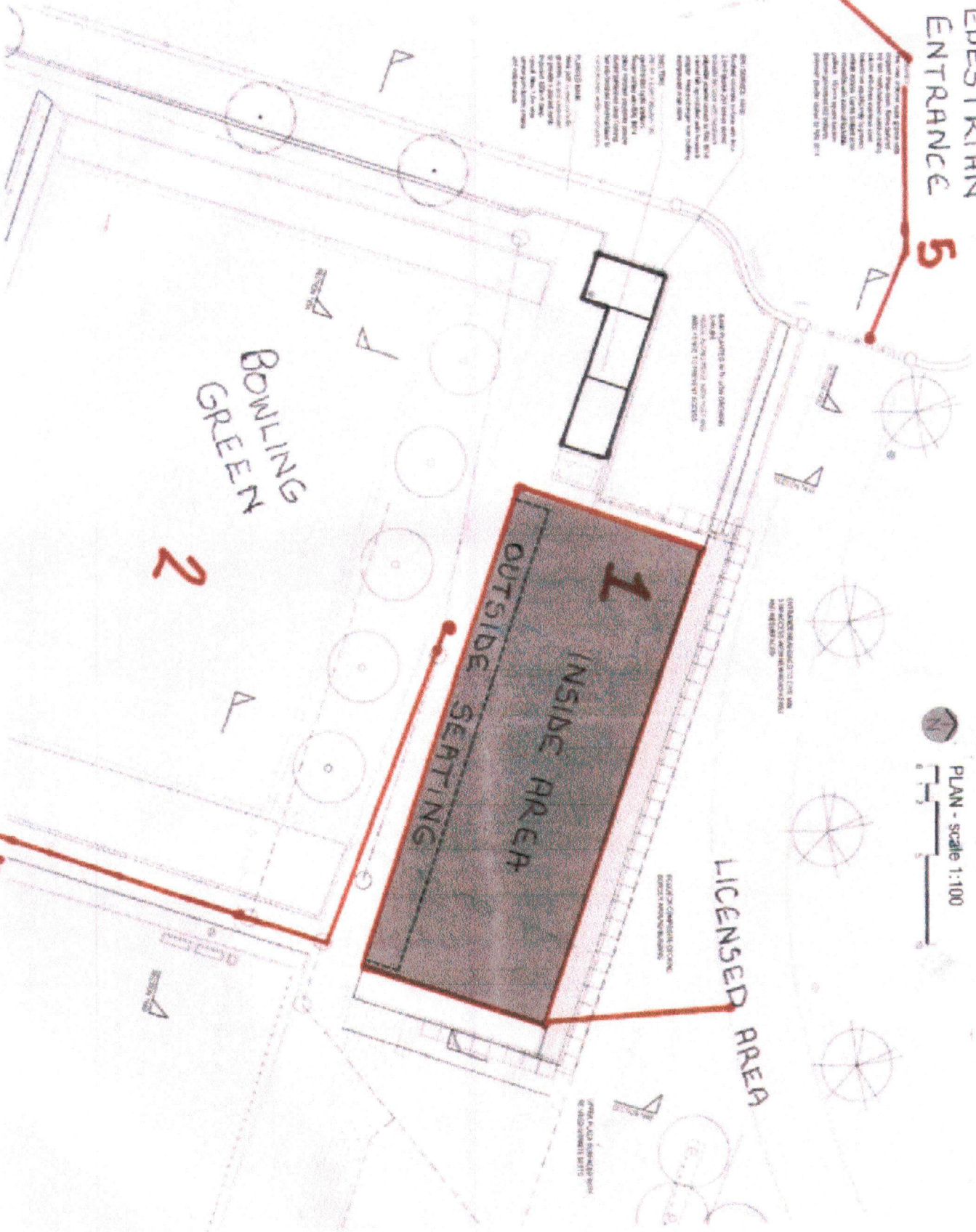

PLAN - scale 1:100

CAR PARK 3

ENTRANCE FROM CAR PARK 4

1. PROPOSED AREA FROM WHICH ALCOHOL WILL BE SERVED.
2. GAMES AREA
3. CAR PARK. TWO DISABLED SPACES CLOSEST TO ENTRANCE
4. ENTRANCE FROM MAIN CAR PARK
5. PEDESTRIAN FROM SINCLAIR ST. DISABLED ACCESS ALSO.

DETAIL AREA 3 - ENTRANCE	
PROJECT	143
DATE	F

ION SIMMONS





THESE PLANS AND SPECIFICATIONS ARE THE PROPERTY OF HOOSKINS ARCHITECTS AND SHOULD NOT BE REPRODUCED OR COPIED IN ANY MANNER WITHOUT THE WRITTEN PERMISSION OF HOOSKINS ARCHITECTS. ANY UNAUTHORIZED REPRODUCTION OR COPIING OF THESE PLANS IS STRICTLY PROHIBITED AND WILL BE PROSECUTED TO THE FULL EXTENT OF THE LAW.

NO.	DESCRIPTION	QUANTITY	UNIT	PRICE	TOTAL
1	CONCRETE FOUNDATION	100	m <sup>2</sup>	150	15000
2	CONCRETE SLAB	200	m <sup>2</sup>	100	20000
3	BRICK WALL	500	m <sup>2</sup>	200	100000
4	GLASS WINDOW	100	m <sup>2</sup>	1000	100000
5	ROOFING	1000	m <sup>2</sup>	100	100000
6	MECHANICAL	100	h	1000	100000
7	ELECTRICAL	100	h	1000	100000
8	PLUMBING	100	h	1000	100000
9	PAINT	1000	m <sup>2</sup>	100	100000
10	LABOUR	10000	h	100	1000000
11	CONTINGENT	100000	£	100000	100000
12	TOTAL				3000000

**HOOSKINS ARCHITECTS**  
 100, Market Street, Sydney, NSW 2000  
 Tel: (02) 9555 1234  
 Fax: (02) 9555 5678  
 Email: info@hooskins.com.au  
 Website: www.hooskins.com.au

**CLIENT:** ABC COMPANY  
**PROJECT:** COMMERCIAL BUILDING  
**DATE:** 15/10/2023  
**SCALE:** 1:50